

BIG LOTS! SHOPPING CENTER



Depicts adjacent Target/Michaels anchored shopping center with reciprocal access and parking to Big Lots Shopping Center.

FEATURES:

- ◆ 50,000 square foot Big Lots anchored Shopping center situated in the heart of the Chula Vista Commercial/Retail thoroughfare.
- ◆ New 6,600 s.f. Pad Building currently under construction (See site plan on back).
- ◆ Pad is situated directly adjacent to Target and Costco anchored retail centers.
- ◆ Starbucks and Gamestop are co-tenants in Pad Building.
- ◆ Two spaces remaining in pad building - 2,000 s.f. & 1,500 s.f.
- ◆ New Walmart planned to be built next door.
- ◆ Abundant on-site parking.

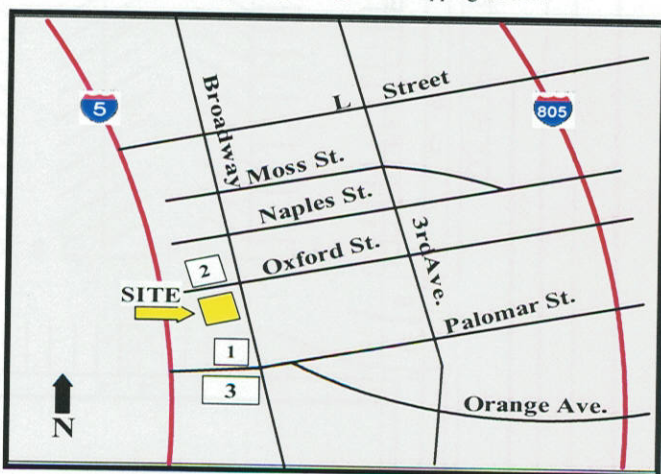

TRAFFIC COUNT:

| | |
|---------------|-------------------|
| Broadway: | 25,300 ADT |
| Oxford: | 6,500 ADT |
| Total: | 31,800 ADT |

1. Target—currently under construction renovation
2. Walmart/Costco—planned redevelopment
3. Food 4 Less, Tweeter, Blockbuster anchored power center.

DEMOGRAPHICS:

| | <u>1 Mile</u> | <u>3 Miles</u> | <u>5 Miles</u> |
|--------------------|---------------|----------------|----------------|
| Population: | 30,095 | 198,483 | 320,062 |
| Average HH Income: | \$35,104 | \$44,367 | \$47,152 |

SWC Broadway & Oxford Street
Chula Vista, California

Contact For Information:

Dan Malcolm

Phone: (858)453-9990

Email: dan.malcolm@coldwellbanker.com

COLDWELL BANKER COMMERCIAL
RETAIL PROPERTIES GROUP
3262 Holiday Court Suite #100
La Jolla, CA 92037



© 2002 Coldwell Banker Real Estate Corporation. Coldwell Banker Commercial® is a licensed trademark of the Coldwell Banker Real Estate Corporation. Each Office is Independently Owned and Operated. An Equal Opportunity Employer.

The information herein has been obtained from sources believed to be reliable. While we do not doubt its accuracy, we have not verified it and make no guarantee, warranty, or representation about it. It is your responsibility to independently confirm its accuracy and completeness. You and your advisors should conduct a careful independent investigation of the property to determine to your satisfaction the suitability of the property for your needs.

Site Plan

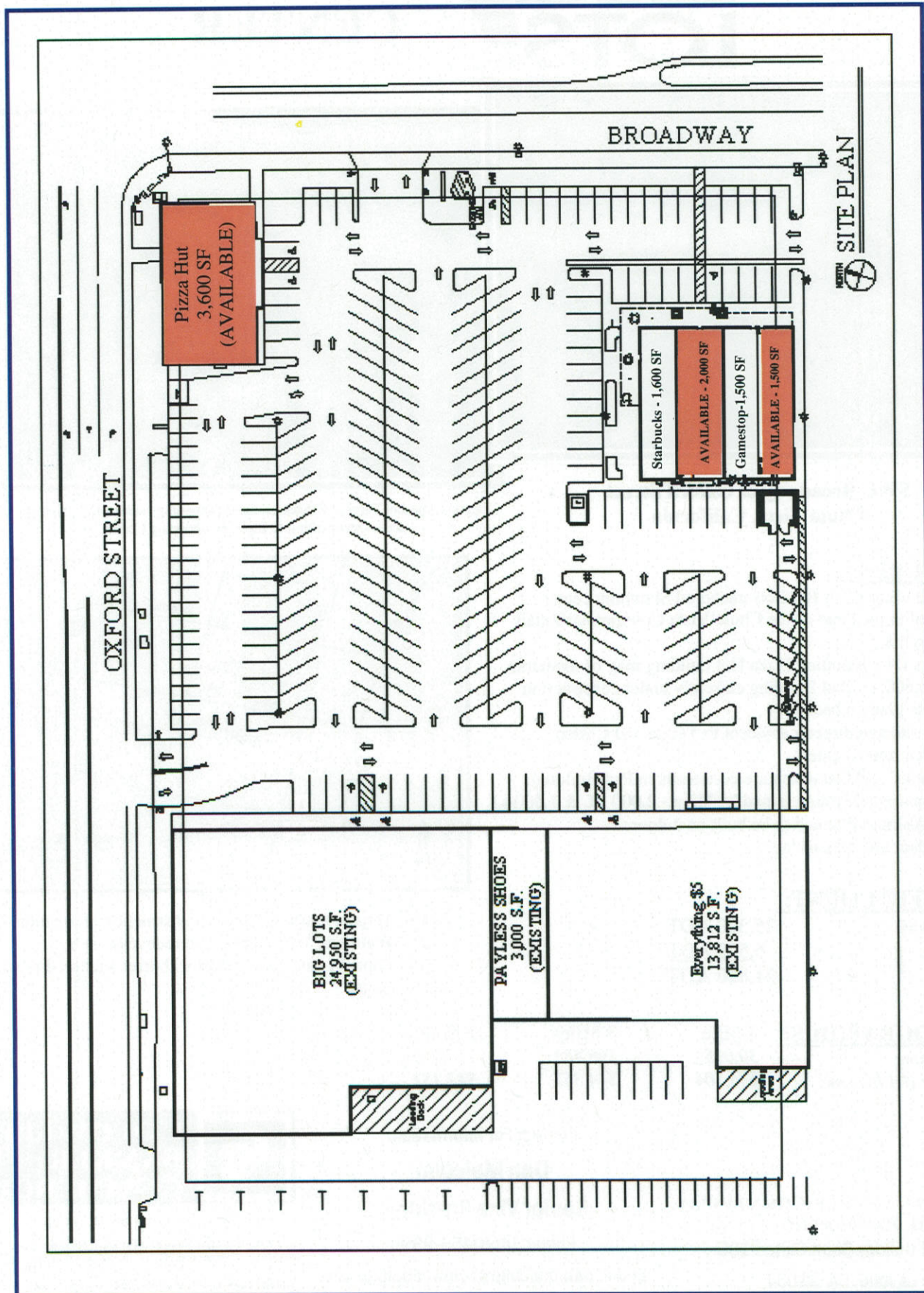

Retail Properties Group